

# THE COTTAGE

138sqm LIVING AREA

Designed with the compact block in mind The Cottage offers a combination of contemporary good looks and intelligent use of available space.

At only 11.1m wide The Cottage leaves plenty of room to accommodate your pool and outdoor entertainment area.

Three bedrooms featuring built-in robes, stacks of storage space, and the elimination of a long hallway combine brilliantly with the character of the home.

Whether you live in the country or the city, or if you have a small or large family, you'll find we have a home to suit your lifestyle and budget.

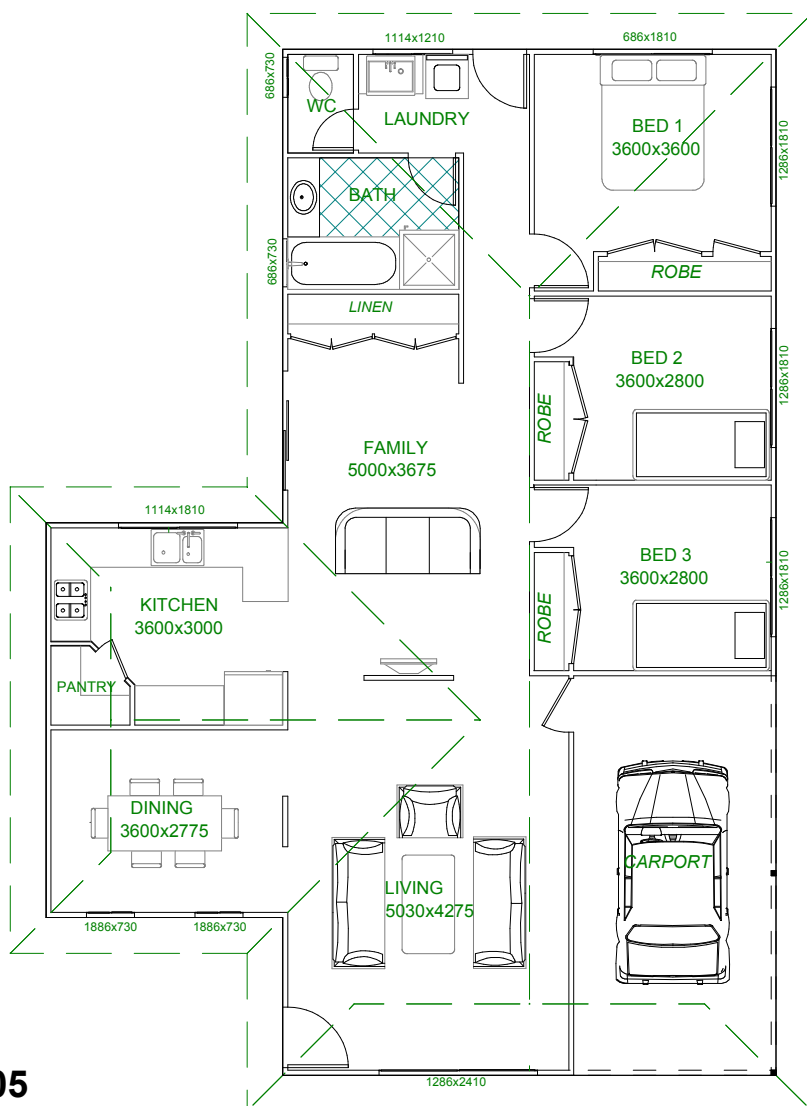

## PRICING

**VALUE SPEC LOCK-UP \$63,405**  
**FULL KIT \$79,010**

**PREMIUM SPEC LOCK-UP \$68,325**  
**FULL KIT \$85,155**

**INCLUDES DELIVERY WITHIN 150KM OF THE CBD**

